

Solutions for Perfection from Marin Industrietechnik

Heavy Weight Weaving Shuttles BLK-N1

- *10-15 % Higher productivity utilization*
- *Cost reduction due to long life materials*
- *Cost saving due to modular construction*
- *No weaving marks on the fabric*

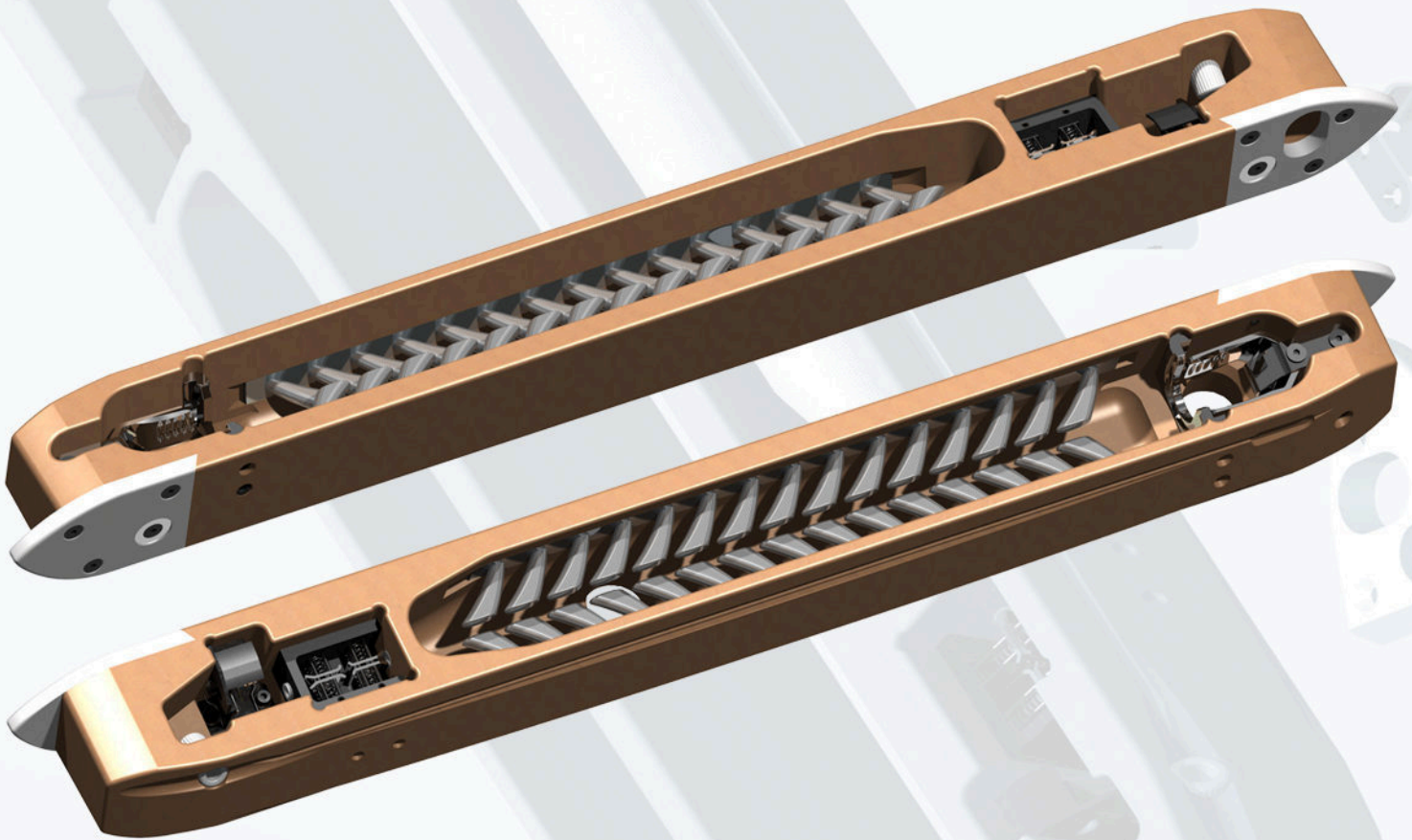

Regional Agent 區域代理:
A&A Consultant 香港A&A諮詢

www.hkaac.net

@: info@hkaac.net ☎: +852-9023 4800

✉: PO Box 143, Tung Chung, HONG KONG (香港)

MARIN
Industrietechnik

Weaving Shuttles Type BLK-N1

High-Tec Shuttle type BLK-N1, with polished sliding skids and full equipment. Application: Felt weaving looms with HPII hydraulic insertion system, equipped with an automatic pirn changer on the left side of the loom. Could also be used at looms with manual pirn change and rectilinear or inclined pirn changer shuttle-tables.

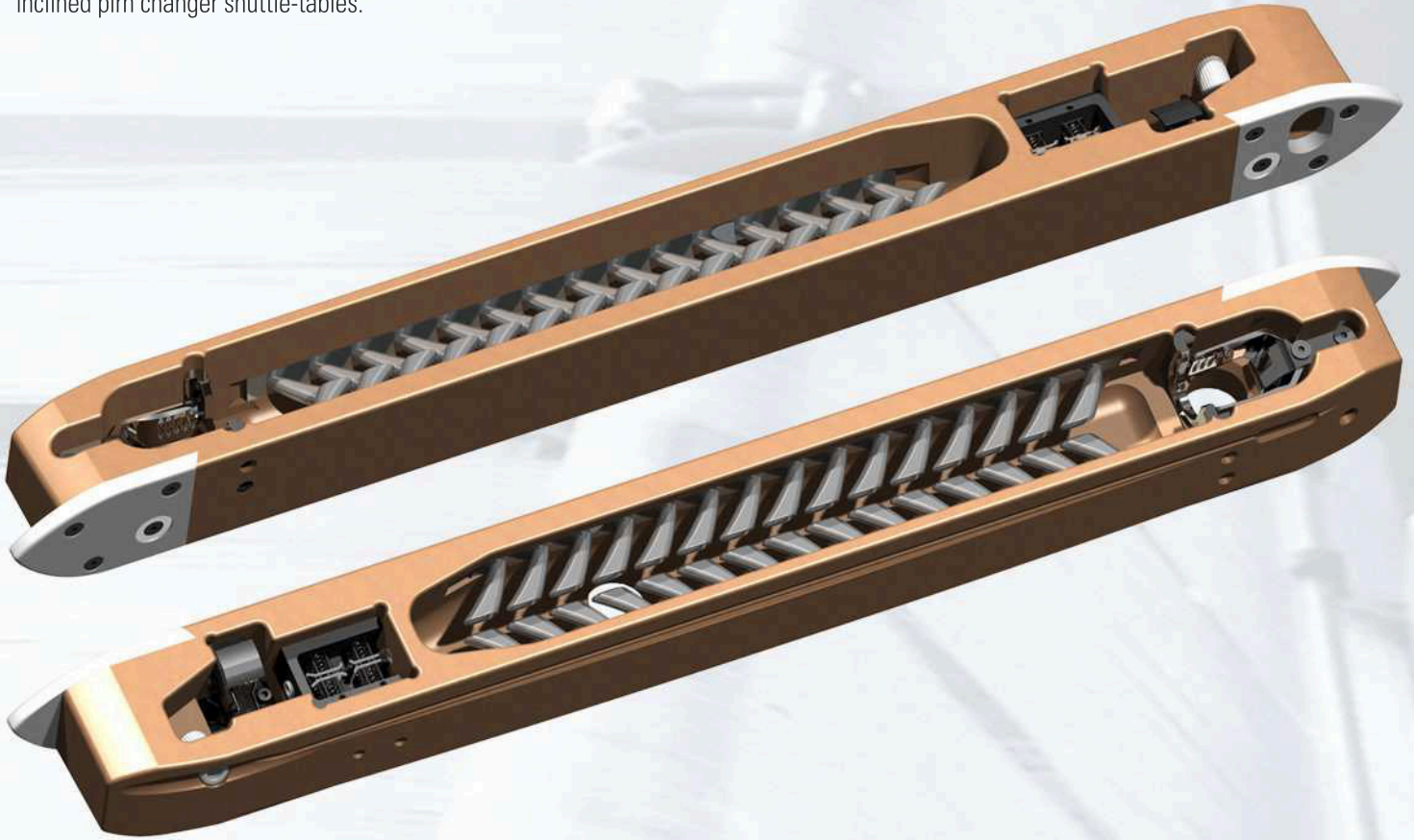

Full equipment:

2 Ceramic eyelets, 1 Shuttle nose type BLL, 1 Shuttle nose type BLR, 2 Sensor plates type B, 1 Slide bow type B, 1 Clamping spring, 1 Pirn holder type A, 1 Yarn cutter type B and 1 Filling brake type B. The Brush strips will be integrated customer-specific.

Shuttle dimensions:

750/700 x 80 x 67/58 mm

Option: Could be equipped with 3 types of pirn clamping units

Typ A

Typ B

Typ C

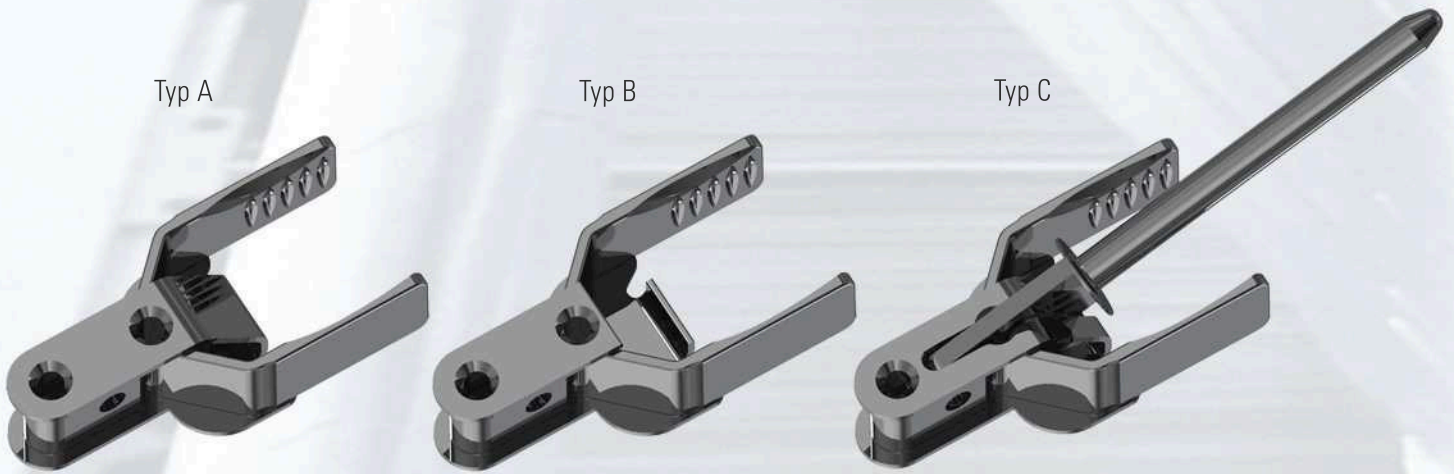

Weaving Shuttles Type BLG-N1

High-Tec Shuttle type BLG-N1 on the highest precision level with basic equipment.

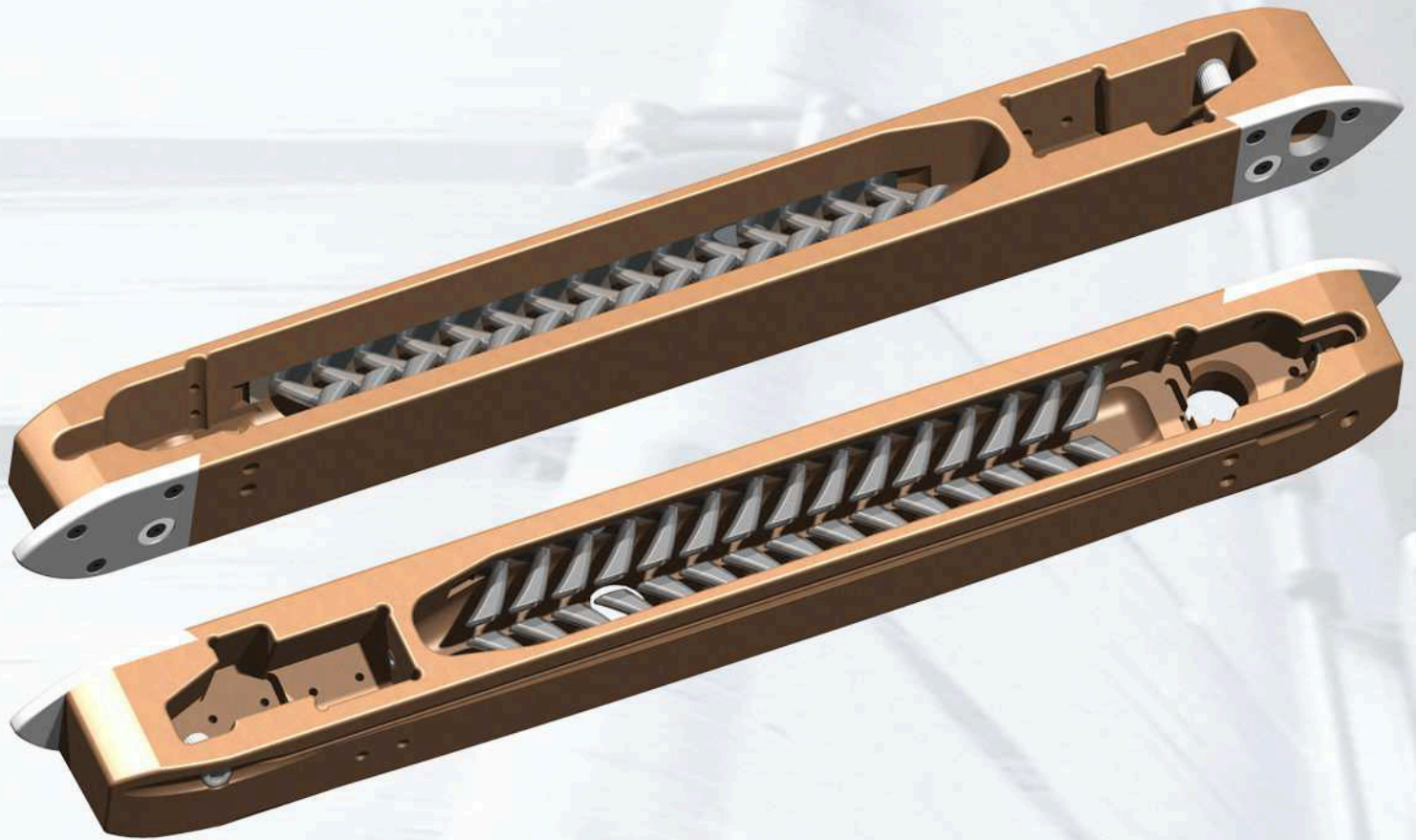

Basic equipment:

2 Ceramic eyelets, 1 Shuttle nose type BLL, 1 Shuttle nose type BLR, 2 Sensor plates type B, 5 locking nuts and 1 socket screw for the clamping spring. The Brush strip is individually integrated.

Shuttle dimensions:

750/700 x 80 x 67/58 mm

MARIN
Industrietechnik

Lechstrasse 2
73529 Schwabisch Gmuend
Germany

fon: + 49 (0) 7171 98 90 52
fax: + 49 (0) 7171 98 90 53

email: info@marin-technik.de
home: www.marin-technik.de